

### SOUTH VALLEY WATER RECLAMATION FACILITY

### Industrial Project

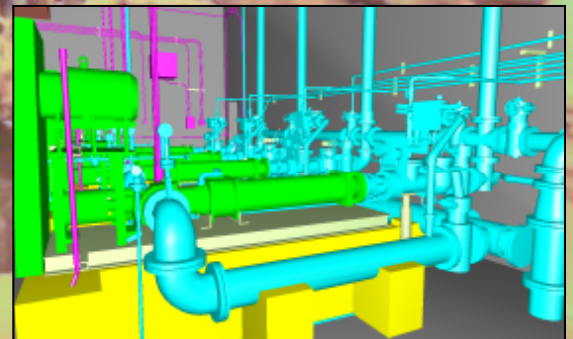

#### PROJECT DESCRIPTION:

- ◆ The South Valley Water Reclamation Facility (SVWRF) is located on the west bank of the Jordan River in West Jordan, Utah. The facility provides wastewater treatment for a 200 square mile area of the south end of Salt Lake County.
- ◆ SVWRF wanted to make improvements to the current facilities at the treatment plant. McNeil Engineering used laser scanning technology to provide accurate, detailed data to the client. All features of the facility 1 inch and bigger were modeled, including pipes, valves, stairs, platforms, pumps electrical boxes, handrails, etc.
- ◆ Using the data provided by McNeil, SVWRF was able to make accurate and precise design decisions for future improvements and new equipment.
- ◆ McNeil Engineering is able to provide more accurate data in a shorter amount of time as compared to using traditional survey methods, thus providing a lower cost to the client.



Michael D. Hoffman PLS  
Email: [mike@mcneileng.com](mailto:mike@mcneileng.com)  
801-255-7700 x. 138