

### MAINTENANCE BUILDING LASER SCAN ANALYSIS “ASBUILT SURVEY”

#### Industrial Project

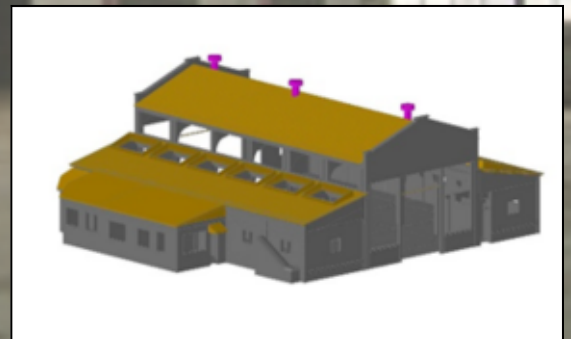

#### PROJECT DESCRIPTION:

- ◆ Safety is important to this client and they have concerns for the safety of the buildings surrounding their refinery.
- ◆ Because there were no record drawings of this facility, McNeil Engineering was tasked with providing As-built Drawings to enable the client to determine the inherent safety of this building. Using laser scanning technology, McNeil was able to provide quick and accurate data to the client.
- ◆ Using the data provided by McNeil Engineering, the client was able to make a structural assessment of the building.
- ◆ McNeil Engineering is able to provide more accurate data in a shorter amount of time as compared to using traditional survey methods, thus providing a lower cost to the client.



Michael D. Hoffman PLS  
Email: [mike@mcneileng.com](mailto:mike@mcneileng.com)  
801-255-7700 x. 138

[www.mcneilengineering.com](http://www.mcneilengineering.com)